

THIS COPY IS PROVIDED ON A RESTRICTED BASIS AND IS NOT TO BE USED IN ANY WAY DETRIMENTAL TO THE INTERESTS OF PANDUIT CORP.

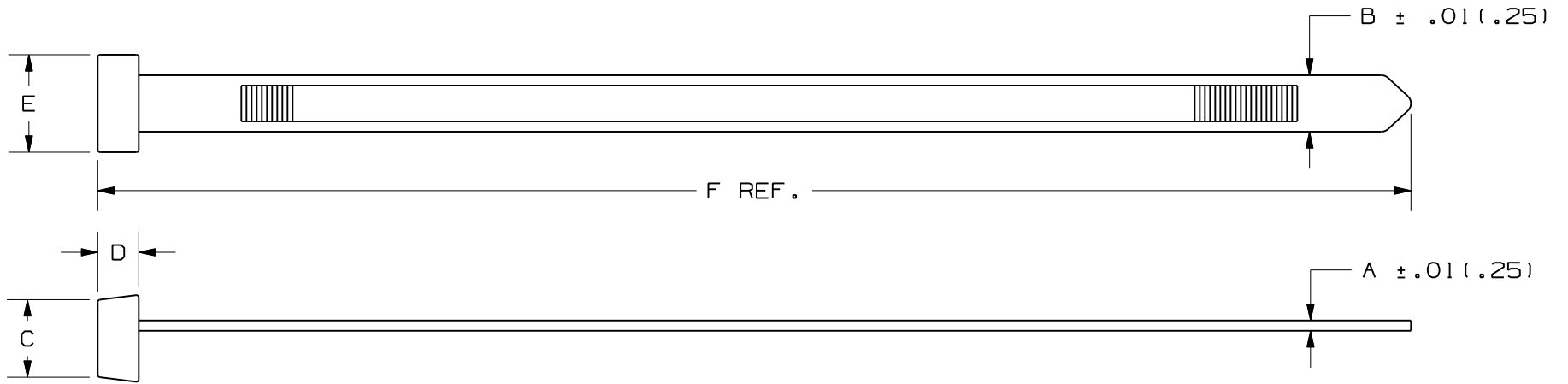

PANDUIT PART NO.*	BUNDLE DIA.		A in (mm)	B in (mm)	C in (mm)	D in (mm)	E in (mm)	F in (mm)	MIN. LOOP TENSILE lbs. (N)	CROSS-SECTION	WEIGHT lbs./100pcs. (g)	RECOMMENDED HOLE SIZE FOR THROUGH PANEL MOUNTING
	MIN. in (mm)	MAX. in (mm)										
SST2HH	.06 (1.5)	2.00 (50)	.062 (1.6)	.300 (7.6)	.472 (11.9)	.250 (6.4)	.590 (14.9)	8.5 (216)	120 (534)	HEAVY	.802 (364)	.316/.520 (8.0/13.2)
SST4HH	.06 (1.5)	4.00 (102)	.062 (1.6)	.300 (7.6)	.472 (11.9)	.250 (6.4)	.590 (14.9)	14.8 (376)	120 (534)	HEAVY	1.3 (538)	.316/.520 (8.0/13.2)

**NOTES:**

\*1) SEE [www.panduit.com](http://www.panduit.com) FOR PART NUMBER SUFFIX DESIGNATION FOR PACKAGE SIZE AND PART COLOR.

W10001EA/09-SS-17819

DIMENSIONS IN PARENTHESES ARE IN METRIC UNITS.

**PANDUIT** CORP. TINLEY PARK, ILLINOIS

**STA-STRAP CABLE TIES  
(HEAVY HEAD)**

UNLESS OTHERWISE SPECIFIED,  
DIMENSIONAL TOLERANCES ARE:  
(.X) ± .0005 (XXX) ± .020(.51)  
(.XX) ± .02(.5) ANGLES ± .0005

UNLESS OTHERWISE SPECIFIED,  
ALL DIMENSIONS ARE GIVEN  
IN INCHES, THIRD ANGLE PROJECTION.

DRAWN BY  
L. VALDES

MAT'L:

SCALE  
NONE

DATE  
11/10/82

NYLON 6.6

DRAWING NO.  
SS-17819

DWG  
A  
SIZE

REV	DATE	BY	CHK	DESCRIPTION	ECN	R	CUST	SUP
9	11/29/10	JABO	TGS	CHANGED NOTE 1, AND CORRECTED SST2HH LENGTH FROM 8.0 TO 8.5	SS-17819	9	TGS	